

The Imperial Chamber

A venue for every occasion, this state-of-the-art convention facility located on the second floor offers a spacious Pre-Function Area and a divisible hall facility thus being the perfect choice for meetings, sit-down affairs, exhibitions or social receptions.

	LENGTH (FT)	BREADTH (FT)	HEIGHT (FT)	AREA (SQFT)
PART- 1	34	76	11.5	2584
PART- 2	72.5	84.4	11.5	5976
PRE-FUNCTION AREA	106.5	34	12.4	3621

Arrangement & Capacity

THEATRE



520

CLASSROOM



390

RECEPTION



600

ROUND TABLE



264



The Imperial Chamber

FLOOR PLAN

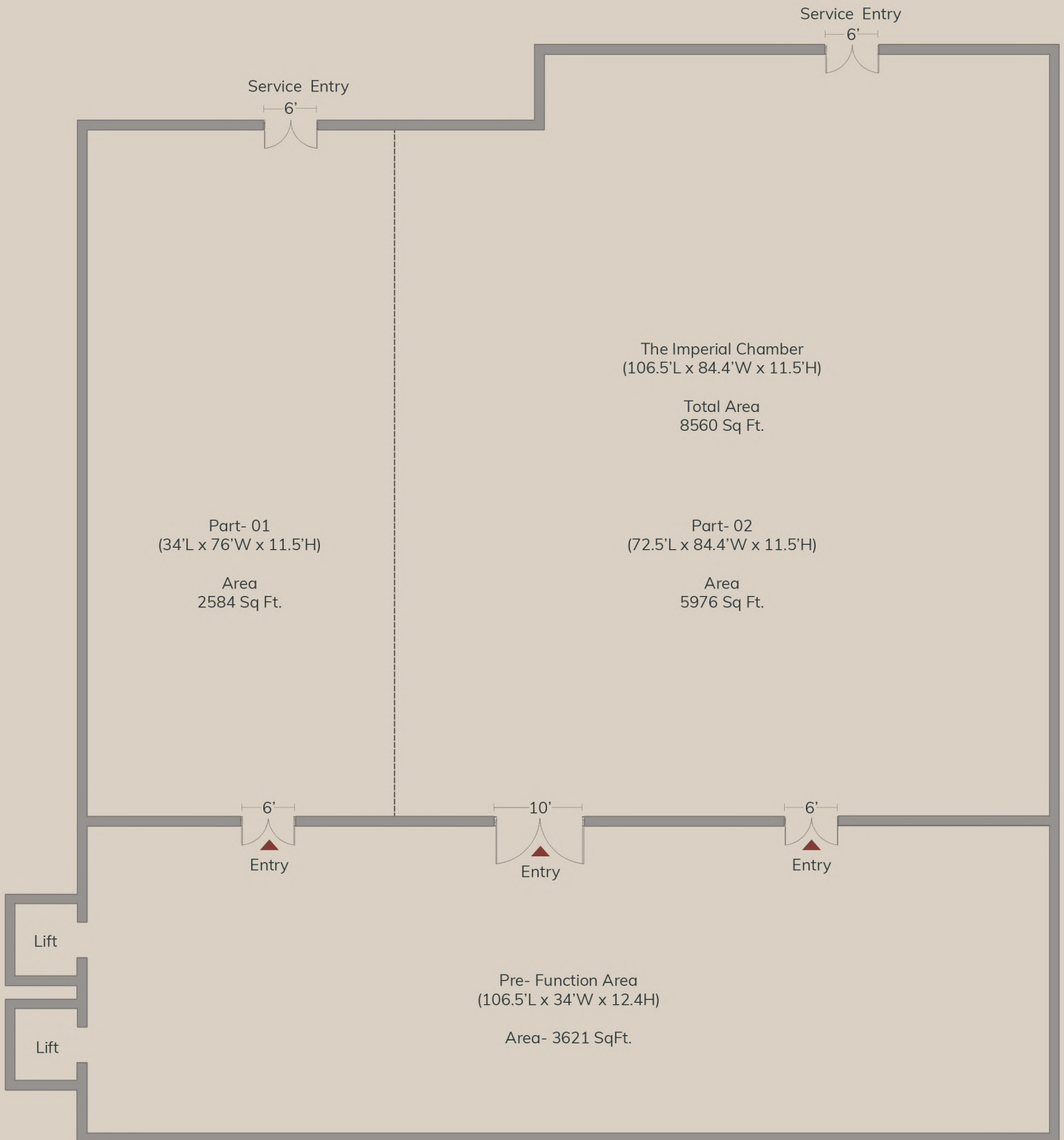

Second Floor

