

The Royal Chamber

A contemporary venue located on the Lobby level, The Royal Chamber is suited for a range of occasions, from conferences to celebrations. Featuring a Pre-Function Area and a grandeur ceiling height, this hall also offers a Live Kitchen facility for interactive culinary action.

	LENGTH (FT)	BREADTH (FT)	HEIGHT (FT)	AREA (SQFT)
THE ROYAL CHAMBER	104	80	26	8320
PRE-FUNCTION AREA	60	30	12.5	1800

Arrangement & Capacity

THEATRE



500

CLASSROOM



390

RECEPTION



600

ROUND TABLE



234



The Royal Chamber

FLOOR PLAN

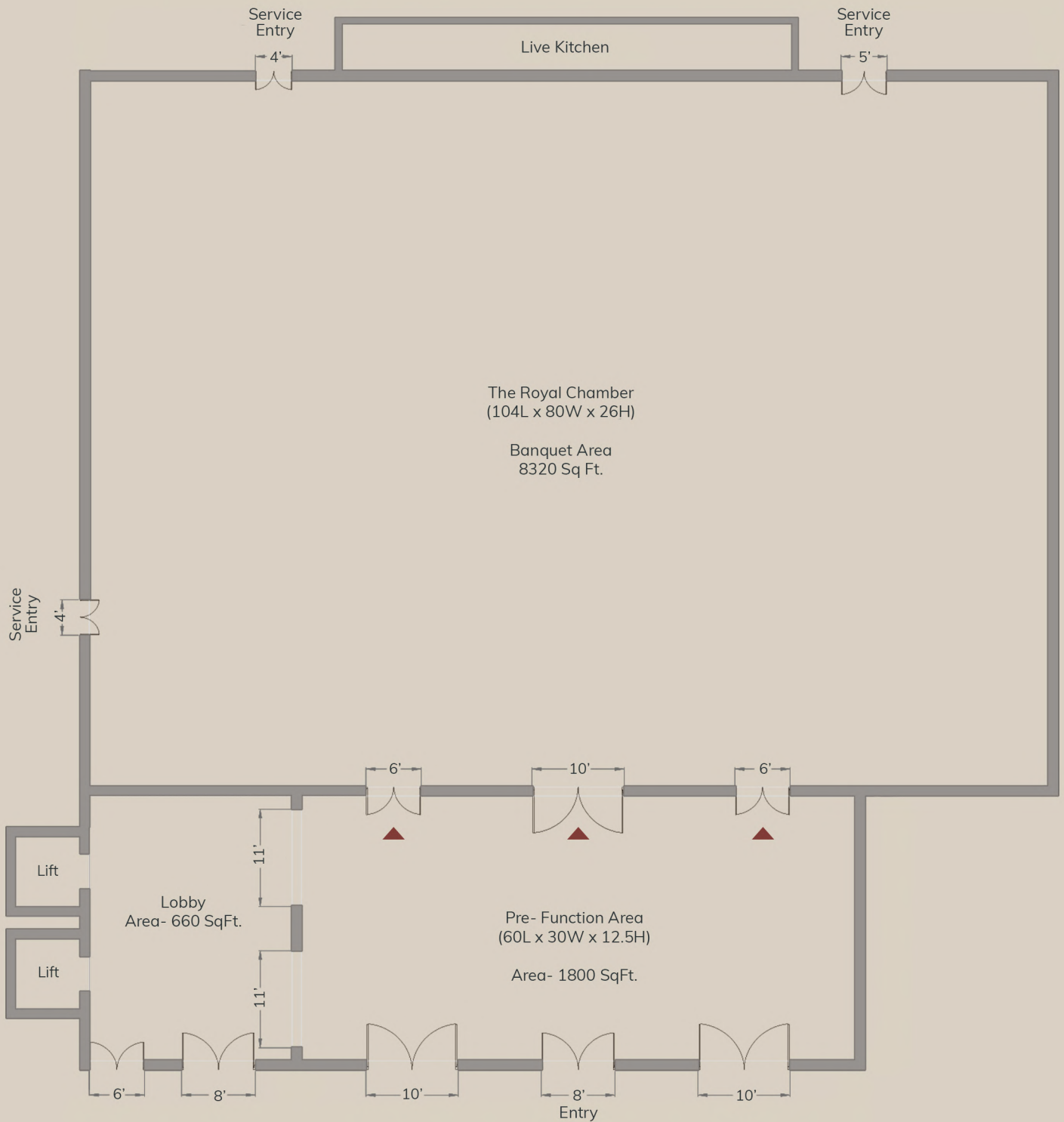

▲
Entry

Main Porch

Ground Floor

